

Cassette Sprocket (7-Speed)
CS-HG20-7 E/bm/bp-Group

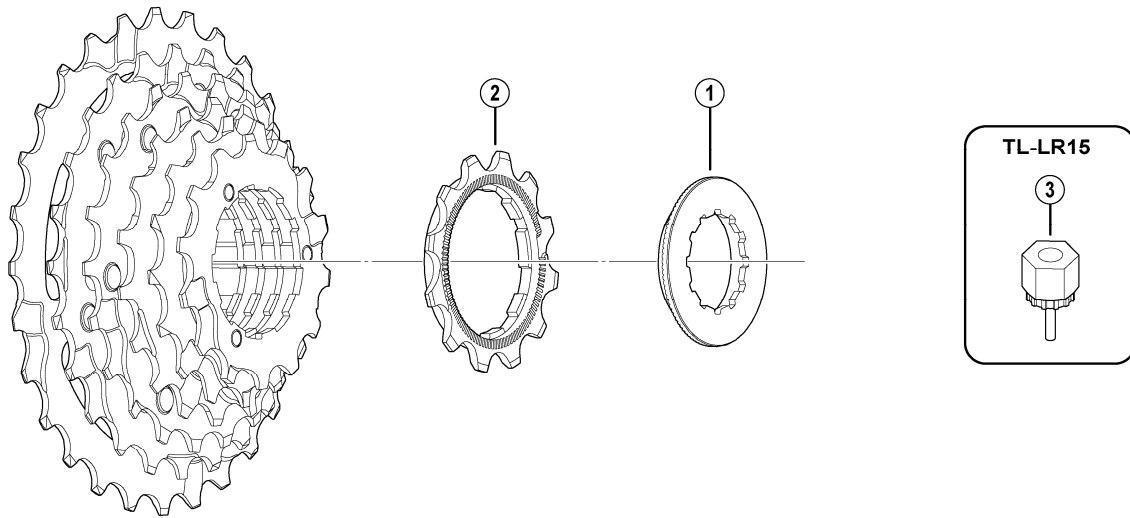

- E-group sprocket teeth combination: 12-14-16-18-21-24-28T
- bm-group sprocket teeth combination: 12-14-16-18-21-24-28T
- bp-group sprocket teeth combination: 12-14-16-18-21-26-32T

CS-HG20-7
E-Group
CS-HG20-7
bm/bp-Group

ITEM NO.	SHIMANO CODE NO.	DESCRIPTION	INTERCHANGEABILITY		
			A	B	
1	Y1YM06000	Lock Ring	A	A	
2	Y11F1205A	Sprocket Wheel 12T (Built in spacer type) for E-Group	A	B	
	Y1YM12000	Sprocket Wheel 12T (Built in spacer type) for bm/bp-Group (Use for bm/bp-Group Only)		A	
3	Y12009230	Lock Ring Removal Tool (TL-LR15)	A	A	

A: Same parts.
 B: Parts are usable, but differ in materials, appearance, finish, size, etc.
 Absence of mark indicates non-interchangeability.

Jul.-2011-3094B
 © Shimano Inc. A

Specifications are subject to change without notice.

SHIMANO